



Paulmann

### Safety Instructions

1, 2, 3, 4, 5, 6, 7, 8, 11, 12, 15, 16, 17, 18, 19, 20, 21, 22, 24, 26, 33, 34



Info

[www.paulmann.com](http://www.paulmann.com)

Paulmann Licht GmbH  
Quezinger Feld 2  
31832 Springe  
Germany

[www.paulmann.com](http://www.paulmann.com)

Art.-Nr.:

**500.74**

(+MA 326) PLD 08/17



Incl.

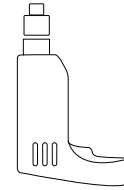
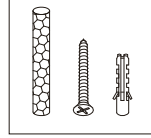

∅ 6mm

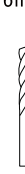

**A**

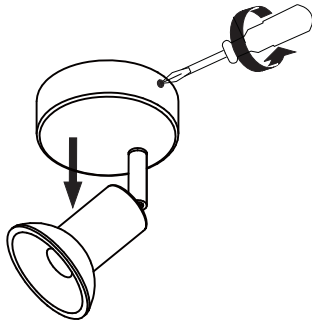

**B**

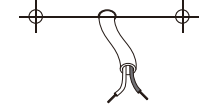
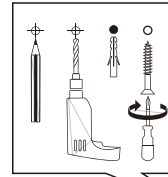

Safety Instructions  
Nr. 4, 5, 6, 7



**C**

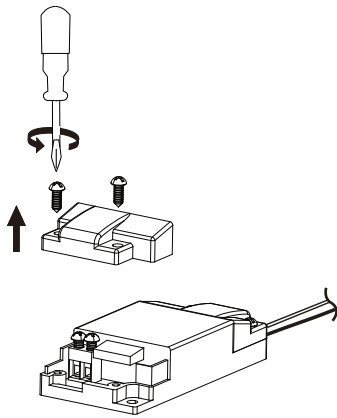

**D**



Safety Instructions  
Nr. 4, 5, 6

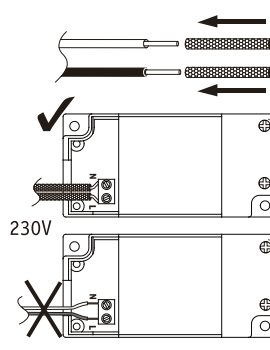
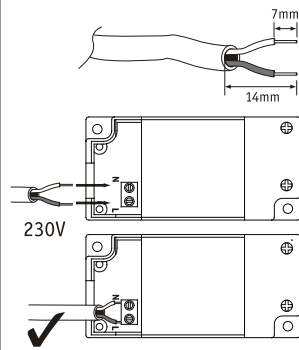

**E**



Safety Instructions  
Nr. 4, 5, 6

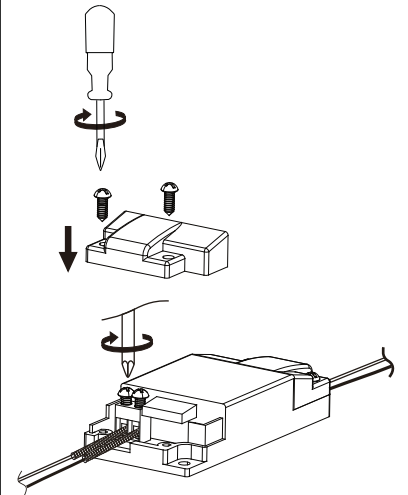

**F**

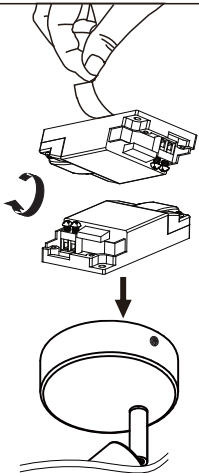

**G**

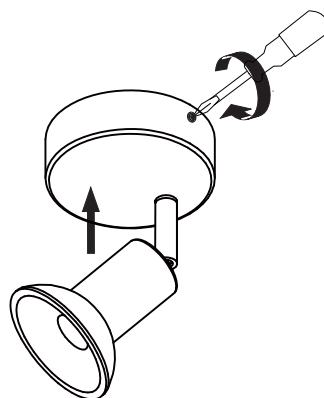

**H**

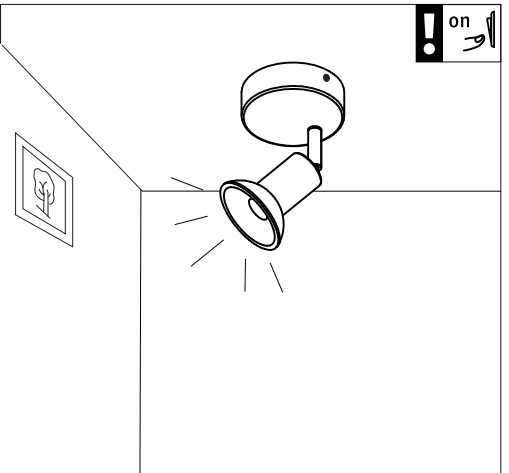

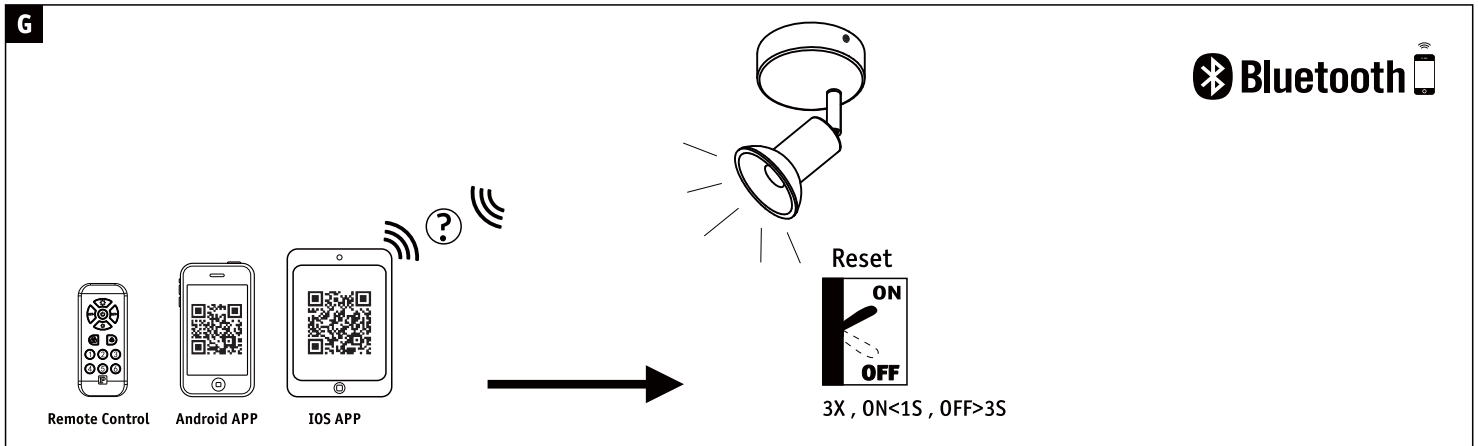
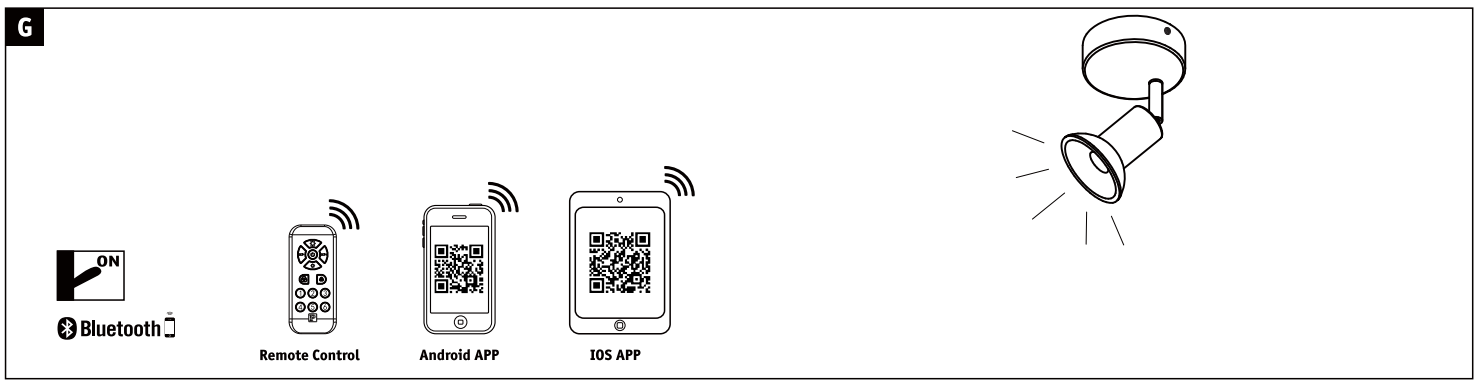

**I**

**Paulmann Home**

IOS APP

Android APP

**Not incl. Smart Device**

- iPad
- iPhone 4S Higher
- Android 4.4 Higher
- Bluetooth 4.0 Higher

**Not incl. Remote Control**

Paulmann Art.-Nr.500.01

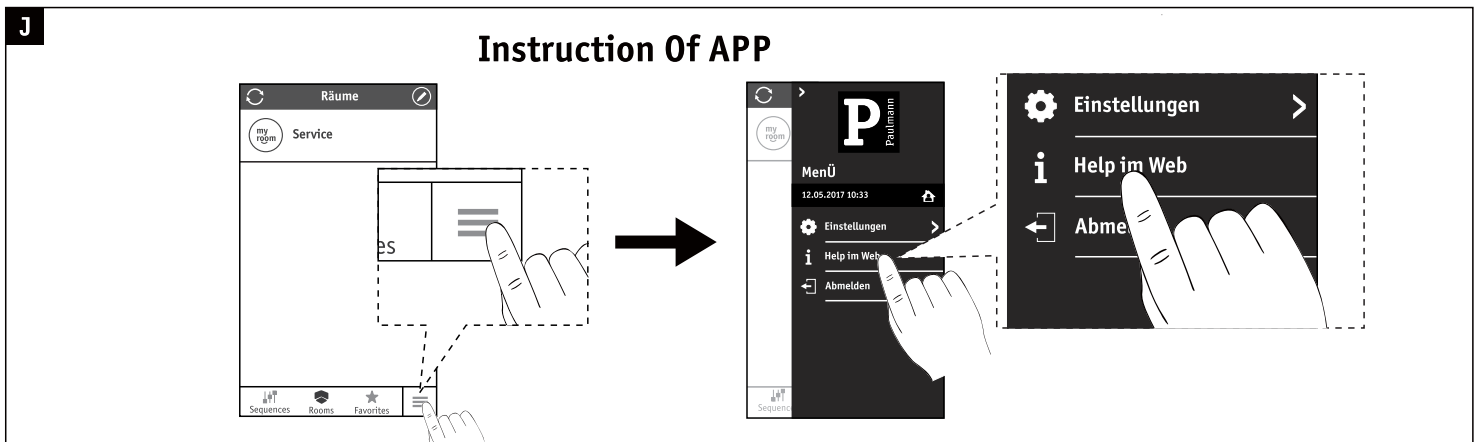

Hiermit erklärt Paulmann Licht, dass der Funkanlagentyp Art.-Nr:500.74 Richtlinie 2014/53/EU entspricht. Der vollständige Text der EU-Konformitätserklärung ist unter der folgenden Internetadresse verfügbar: [www.paulmann.de](http://www.paulmann.de)

Zugelassen für den Betrieb in allen Ländern der EU / Approved for operating in all European countries

CE: Konform mit / in accordance with / conformément a 2014/30/EU, 2014/53/EU <http://www.paulmann.com/de/de/b2b-haendler-log-in.html>

2,4 GHz –  
2,4835 GHz



Doesn't apply for the geographical area within a radius of 20km from the centre on "Ny Alesund"