



Safety Instructions



0, 1, 6, 8, 11, 12, 15,
22, 23, 25, 28



+49 (0) 5041 998 389

Mon. - Do. 7⁰⁰ - 20⁰⁰

Fr. 7⁰⁰ - 17⁰⁰

Paulmann Licht GmbH
31832 Springe / Germany
www.paulmann.com

Art.-Nr.:
701.96/97/98 702.05/
06/07/08/09/10/11/52
53/54/55/56/57/703.09/
10/11/12/17/18/20/21
32/33/36/37/38 704.07
/08/31/36/62/82/83/84
/85 705.02/03/04/05/
06/07/92/93/94
(+MA 173)
POW 12/14

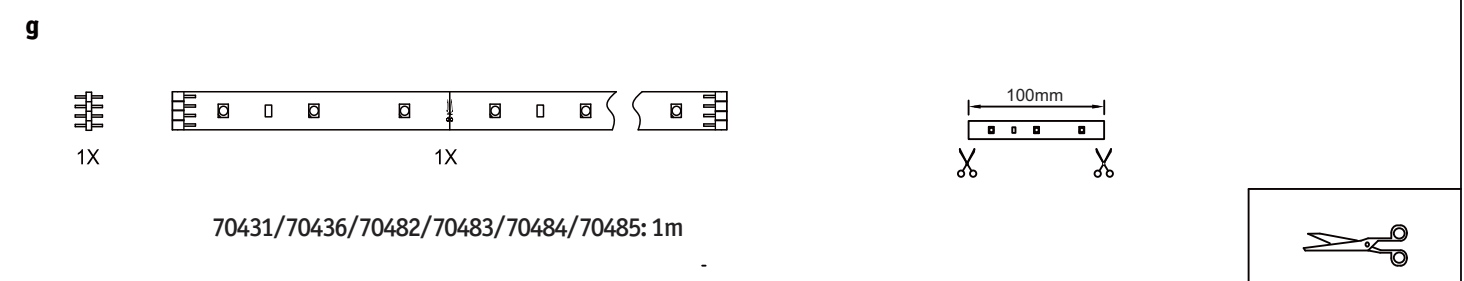
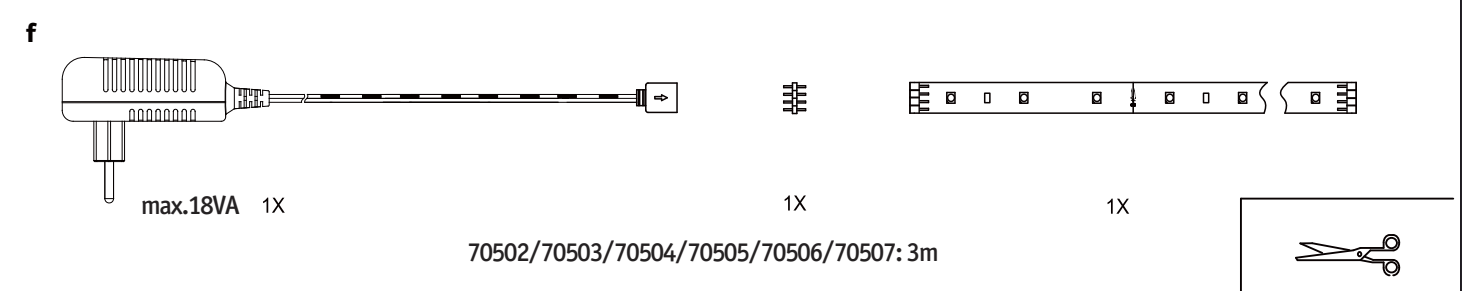
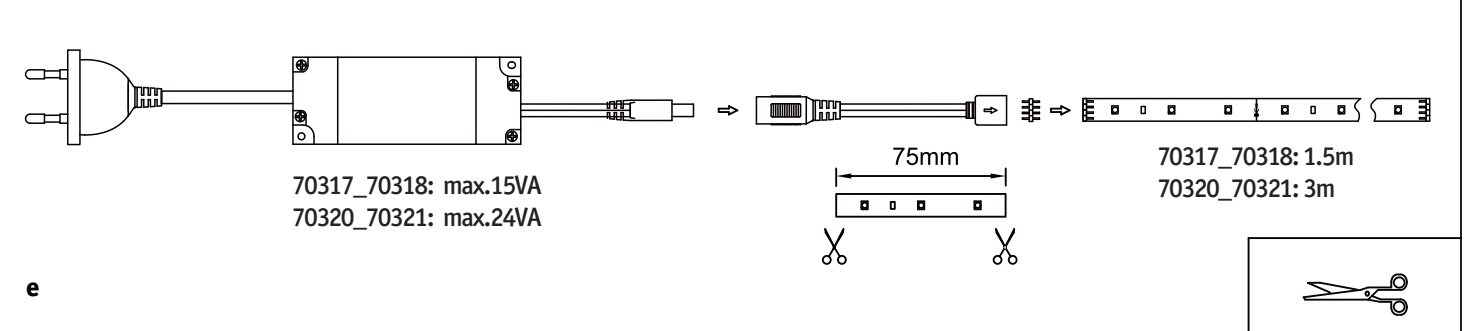
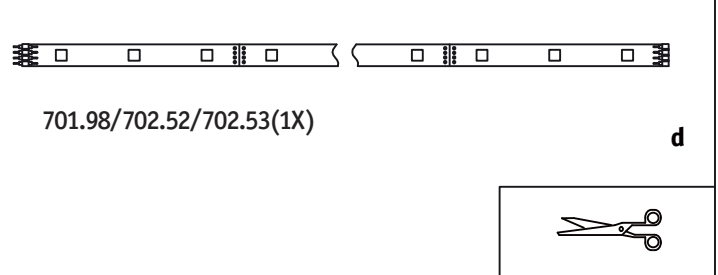
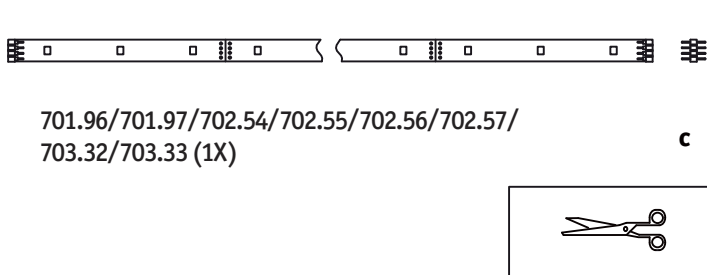
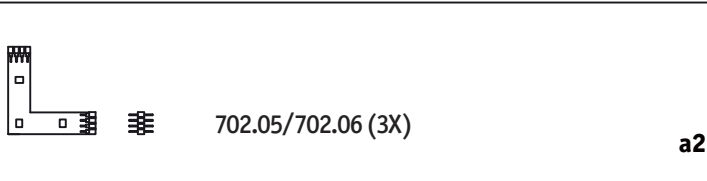
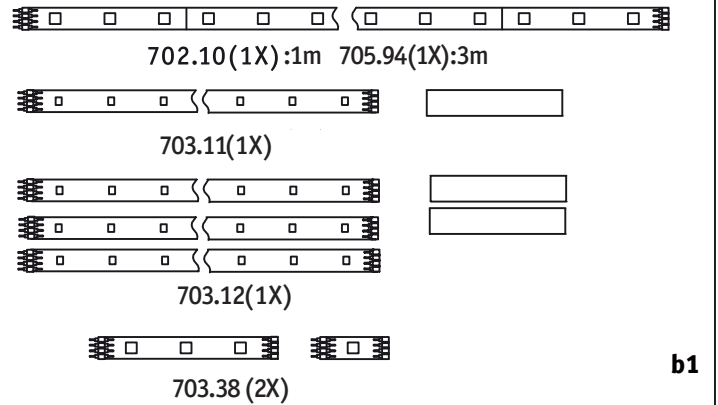
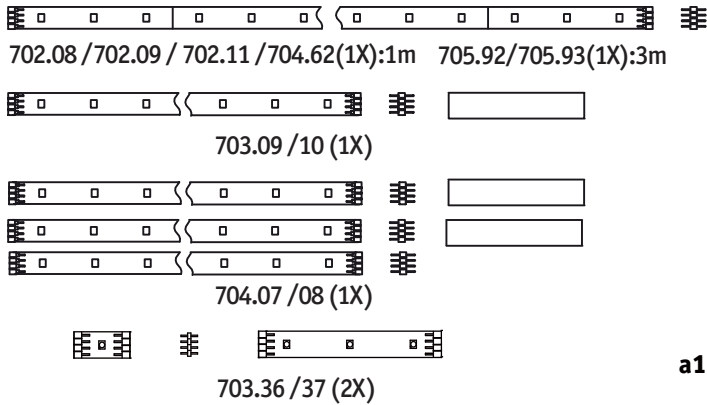

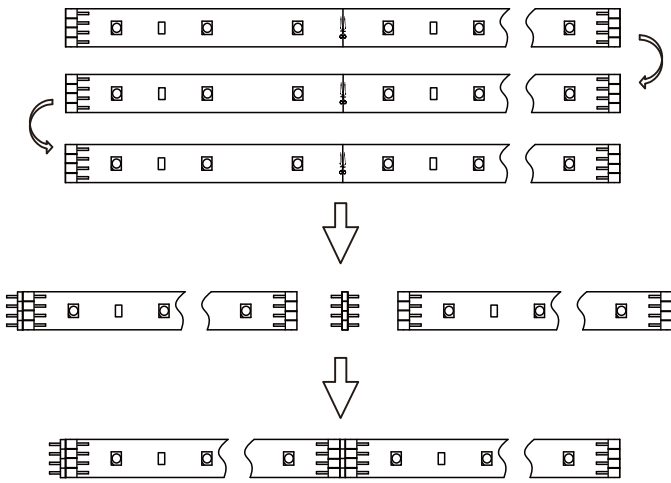
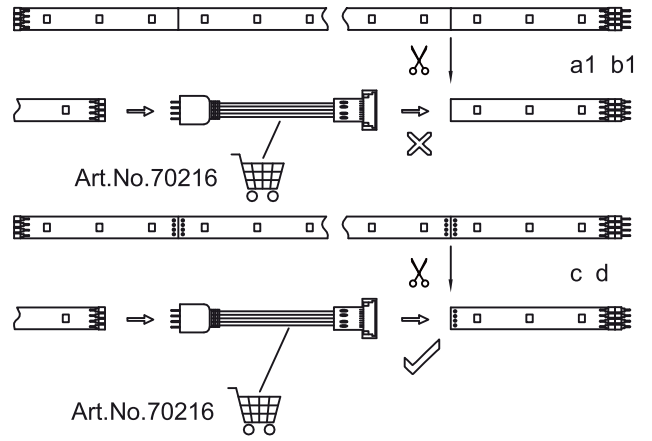
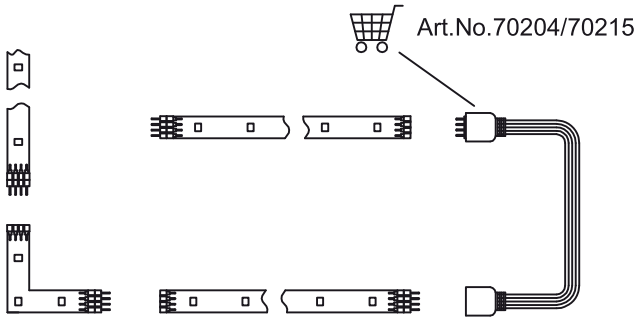
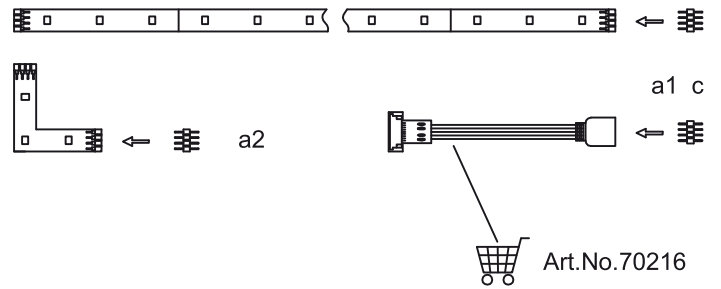
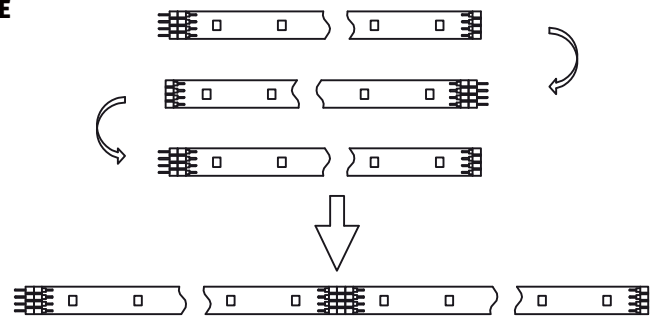
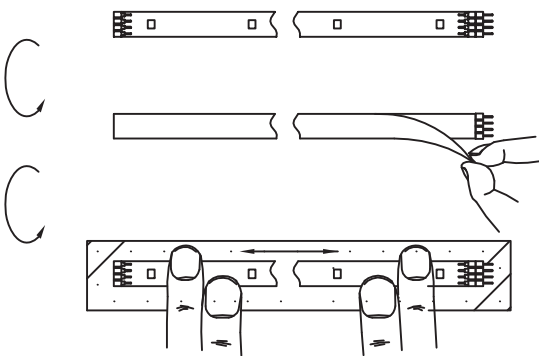
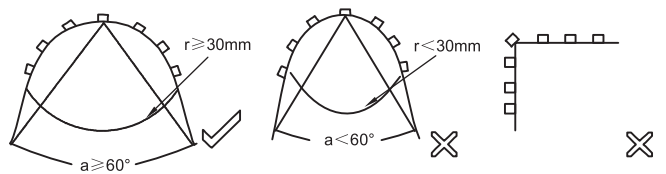
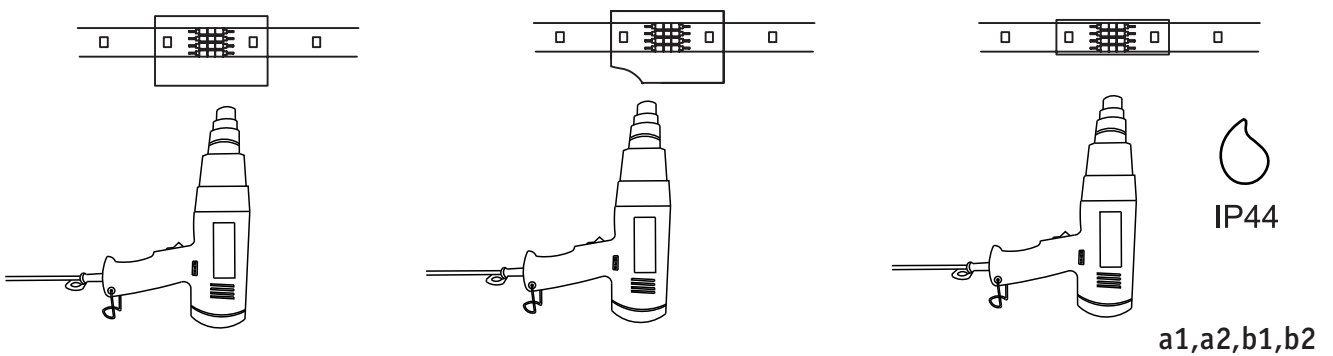
A**B****C****D****E****F****G****H**

a1,a2,b1,b2

I

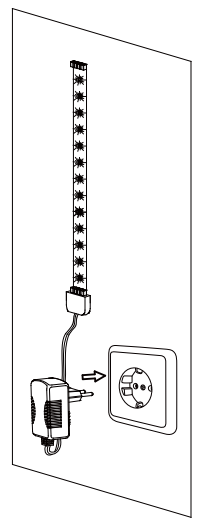
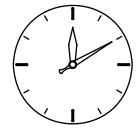

70485/70431 / 70436 / 70482 / 70483/ 70484
70502 / 70503/ 70504 / 70505/ 70506/70507

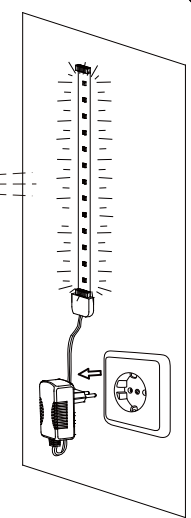

70431 / 70436 / 70482 / 70483/ 70484
70503/ 70504 / 70505/ 70506/70507

J

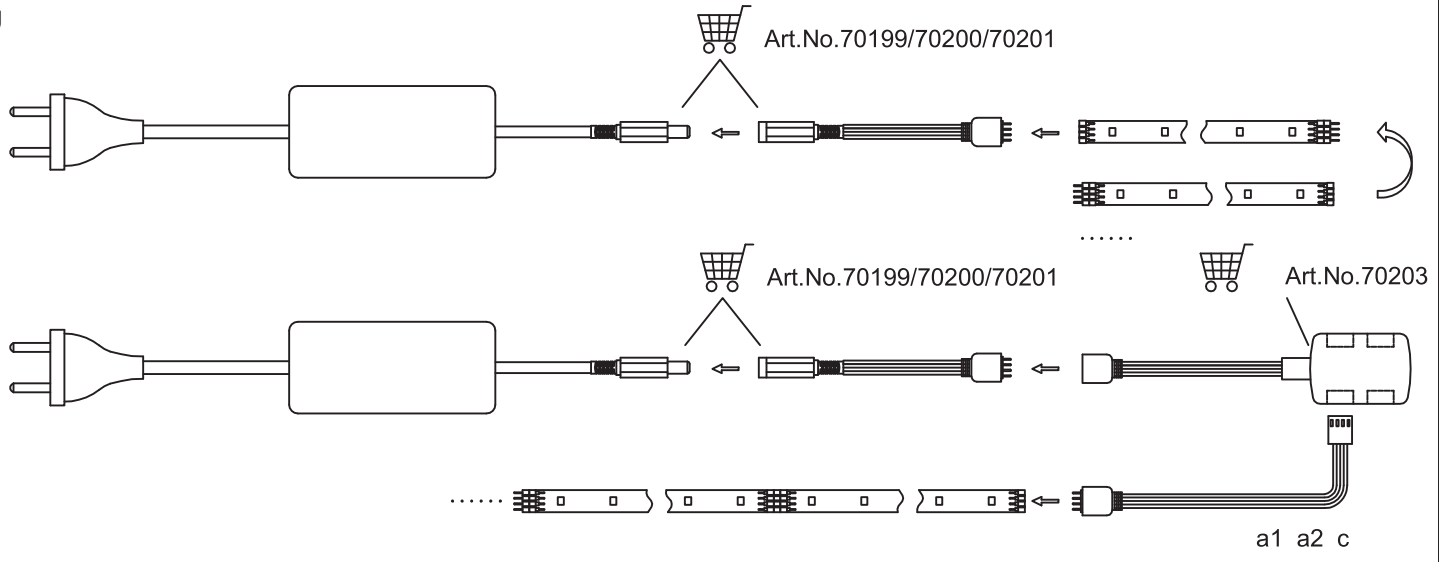

K

