

Safety Instructions



0,1,2,3,4,5b,6,7,8,
9,10,11,12,13,15,16,
17,19,20,21,22,23,25



Info Hotline **+49 (0) 5041 998 389**

Mon. - Do. 7⁰⁰ - 20⁰⁰

Fr. 7⁰⁰ - 17⁰⁰

Paulmann Licht GmbH
31832 Springe / Germany
www.paulmann.com







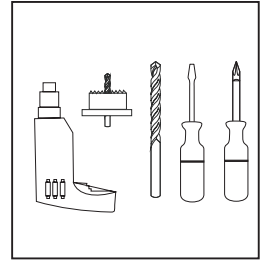
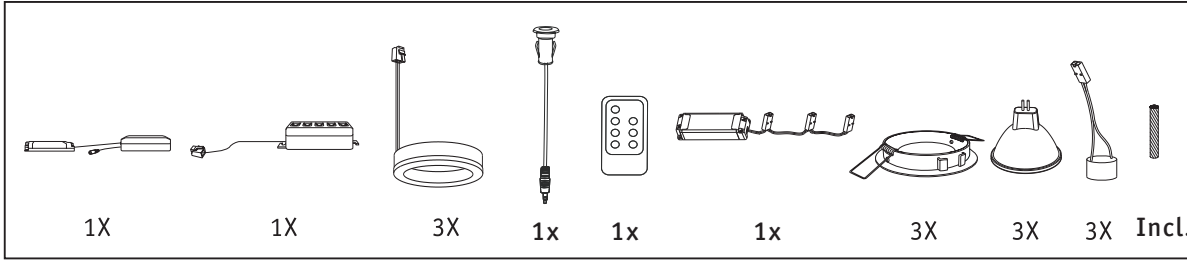

Art.-Nr.:

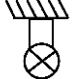
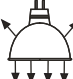
937.60

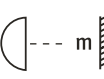
(+MA 173)

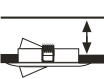
PSU 06/12



							
M M	Akzent Security [W]	[mm]	[m]	[mmø]	[mm]	[cm]	[mm]
	20	51	0,5	68	60	>20	3-20
ø 83mm							

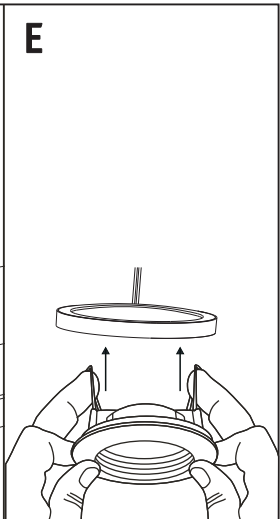
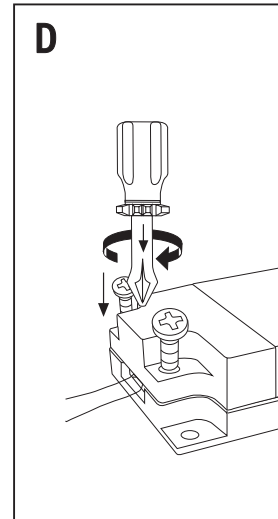
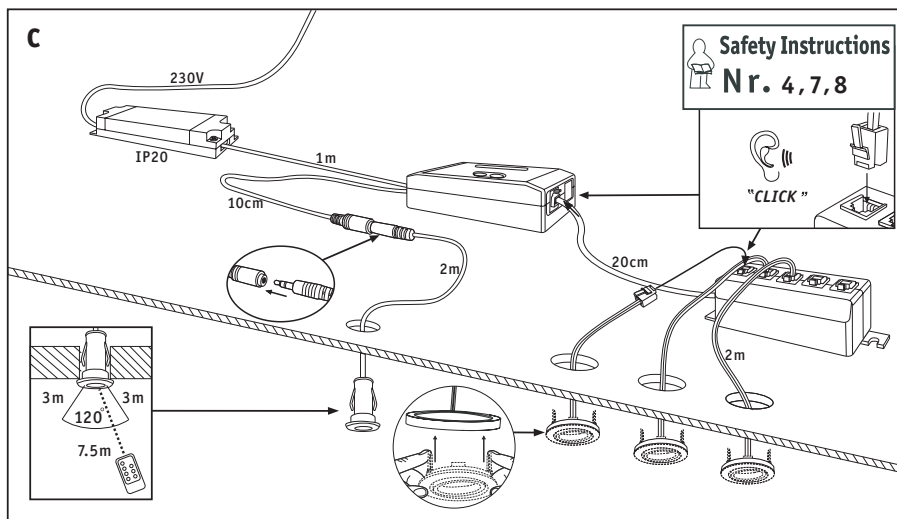
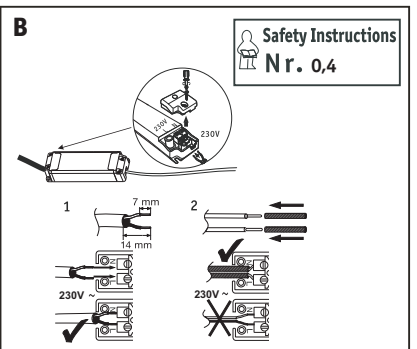
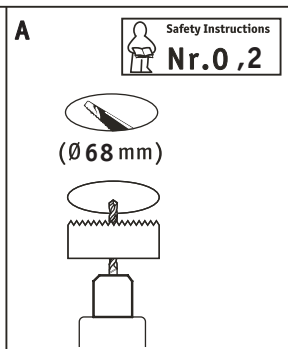
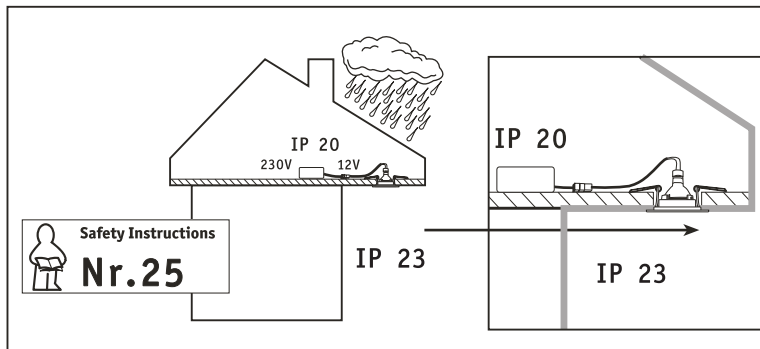
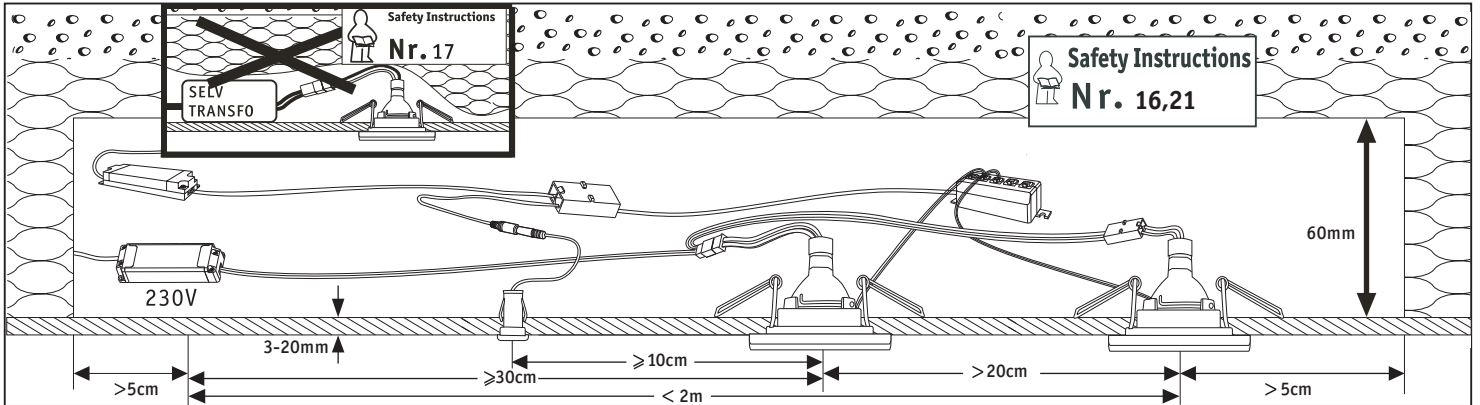

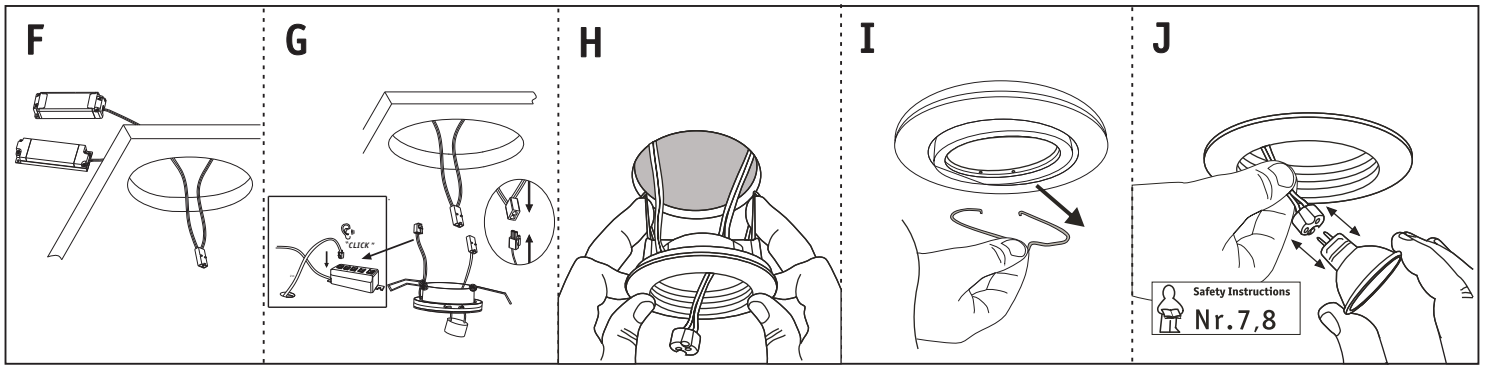

Safety Instructions
Nr. 7,8

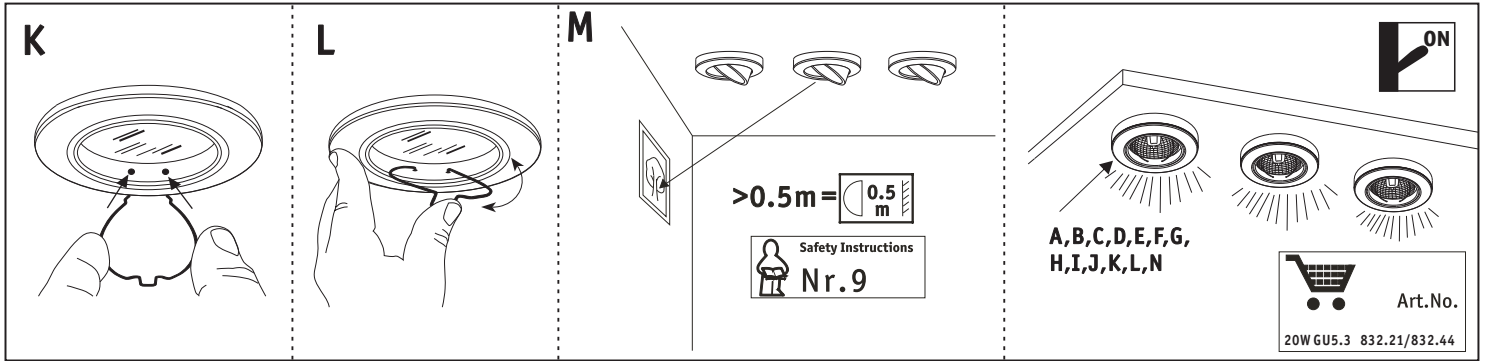

A, B, C, D, E, F, G,
H, I, J, K, L, N

ON

Art.No.
20W 6U5.3 832.21/832.44

P1 **P2** **P3**

Diagram showing the remote control (P2) and its beam spread (P3). The beam spread is a cone with a diameter of 3m at a distance of 3m, resulting in a 120° angle. The maximum distance is $\leq 7.5m$. The remote control has buttons for ON/OFF, MODE, PAUSE, SPEED, WHITE, DIM, and +.

11X MODE

6x

1x WHITE = [Light Bulb Icon]

11) COLOR

1)	COLOR	1	[Light Bulb Icon]
2)	COLOR	2	[Light Bulb Icon]
3)	COLOR	3	[Light Bulb Icon]
4)	COLOR	4	[Light Bulb Icon]
5)	COLOR	5	[Light Bulb Icon]
6)	COLOR	6	[Light Bulb Icon]
7)			[Light Bulb Icon]

8) COLOR

1	2	3	4	5	6	7	1	2	3...
---	---	---	---	---	---	---	---	---	------

9) COLOR

1	1	2	2	3	3	4	4	5	5	6	6	7	7	1	1	2...
---	---	---	---	---	---	---	---	---	---	---	---	---	---	---	---	------

10) COLOR

1	1	1	2	2	2	3	3	3	7	7	7	1	1	1	2...
---	---	---	---	---	---	---	---	---	---	---	---	---	---	---	------

11) COLOR

1	1	2	2	3	3	4	4	6	6	7	7	7	1	1/2...
---	---	---	---	---	---	---	---	---	---	---	---	---	---	--------

P3

1	1	1	1	1	2	2	222 3.
1	1	1	1	2	2	2	2 3333
1	1	1	2	2	2	3	33 4-
1	1	2	2	3	3	4	455-
1	2	3	4	5	6	7	

Q

1. Inserting the remote control into the light fixture.
2. Rotating the light fixture to the desired position.
3. Inserting a CR 2025 3V battery.
4. Securing the battery cover.
5. Final assembly and testing.

CR 2025 3V

CR 2025 3V

CR 2025 3V

! [Warning Icon]

CR 2025 3V