

## Safety Instructions



0,1,4,7,8,9,11,15,  
17,20,22



Info Hotline

+49 (0) 5041 998 389





Mon. - Do. 7<sup>00</sup> - 20<sup>00</sup>

Fr. 7<sup>00</sup> - 17<sup>00</sup>

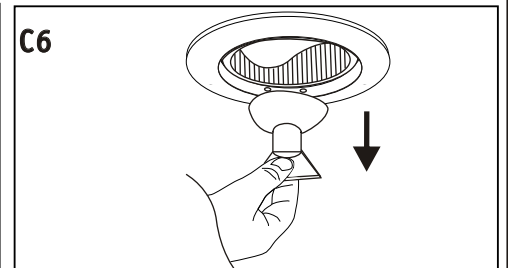
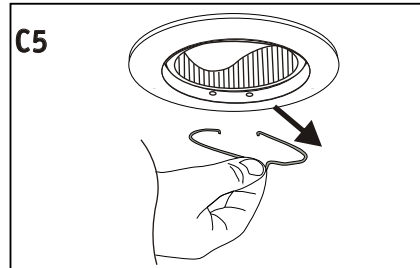
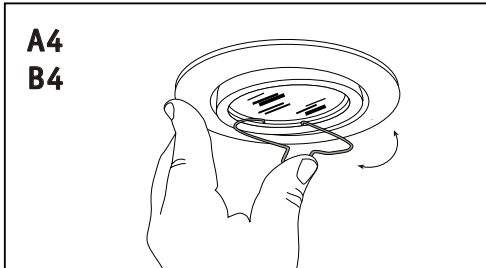
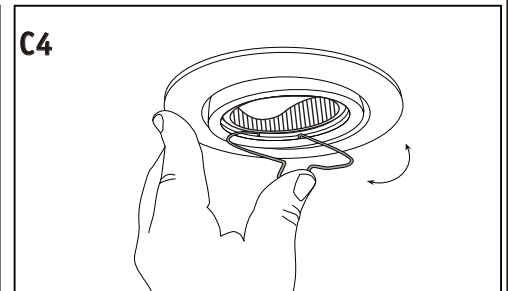
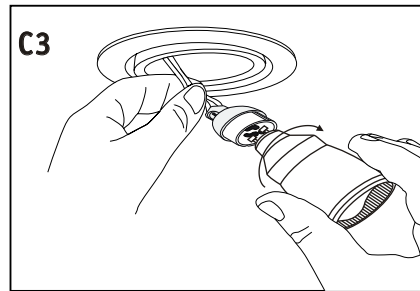
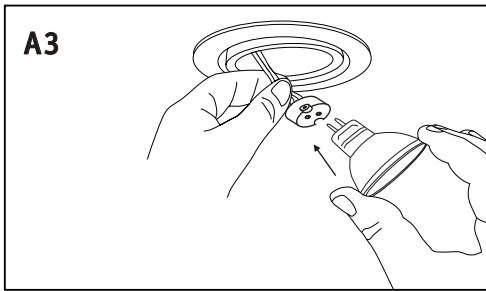
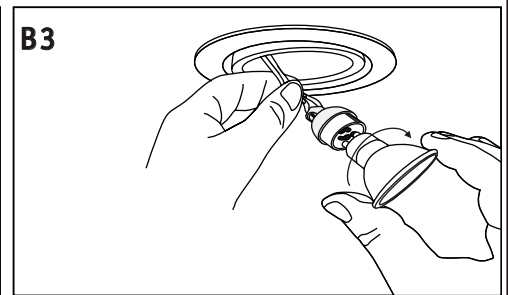
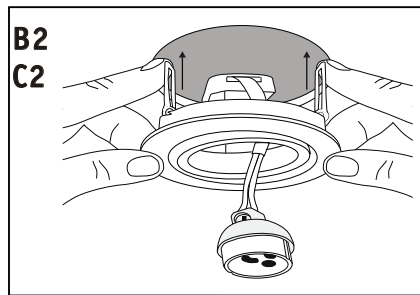
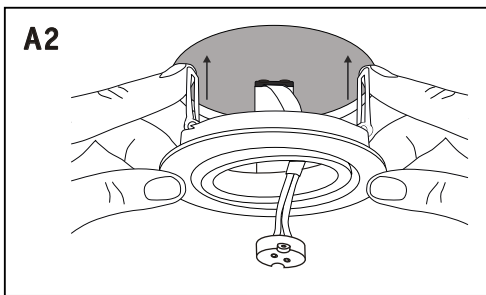
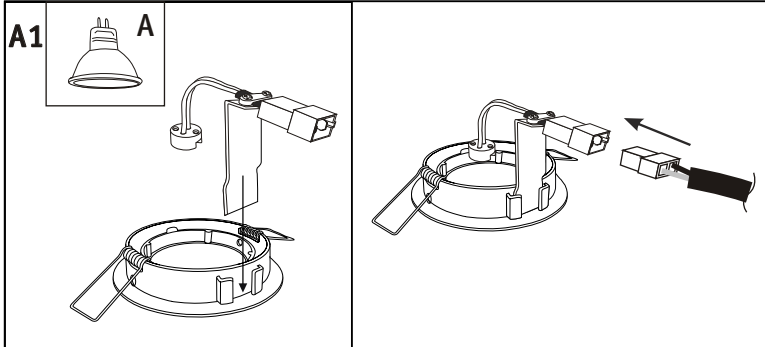
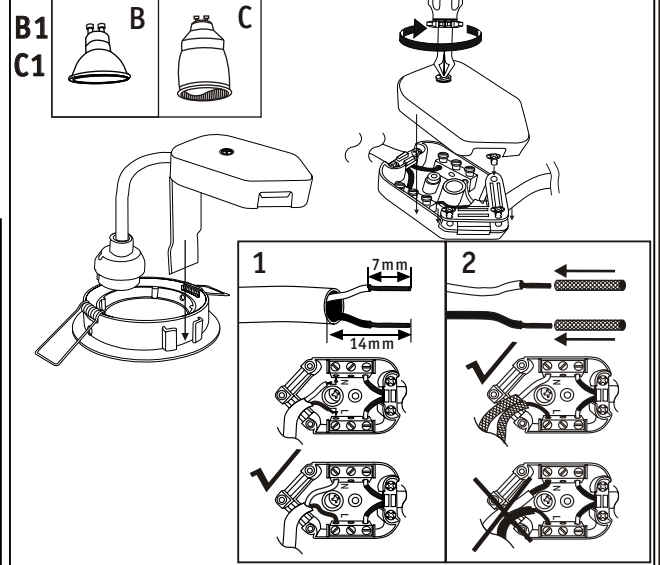
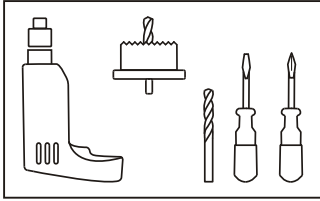
Paulmann Licht GmbH  
31832 Springe / Germany  
www.paulmann.com

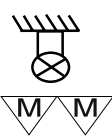
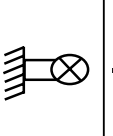
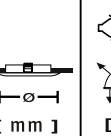
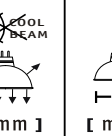
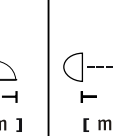
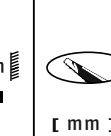
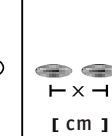
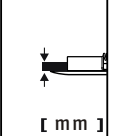
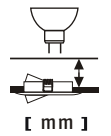
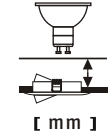
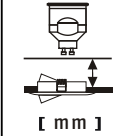
Art.-Nr.:  
965.29/  
997.38/  
39/40/41/  
42/43/44/  
45/49/54/  
55/56  
(+MA 173)  
PBO 11/09



											
[ mm ]	[ mm ]	[ mm ]	[ mm ]	[ m ]	[ mm ]	[ cm ]	[ mm ]	[ mm ]	[ mm ]	[ mm ]	
		79	50	51	0.5	70	≥ 20	5-20	≥ 60	≥ 90	≥ 110
		83	50	51	0.5	68	≥ 20	5-20	≥ 60	≥ 90	≥ 110