

Safety Instructions



1,2,3,5,6,7,8,9,11,12,13,14,15,
16,17,21,26,27,31,32,34,35



Info Hotline

+49 (0) 5041 998 389

Mon.-Do. 7⁰⁰-20⁰⁰

Fr. 7⁰⁰-17⁰⁰



Paulmann Licht GmbH
31832 Springe / Germany
www.paulmann.com

Art.-Nr.:
97538

(+MA 197)

PSL 03/14

LED constant current 350mA

~~LED alternating voltage
12V~AC 50Hz, LED
constant voltage 12V DC~~

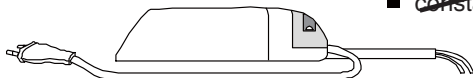

1X

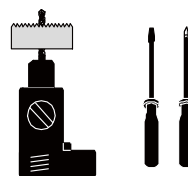

A

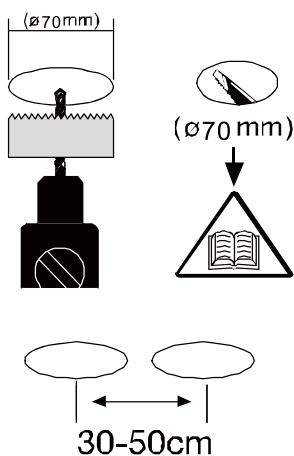

B

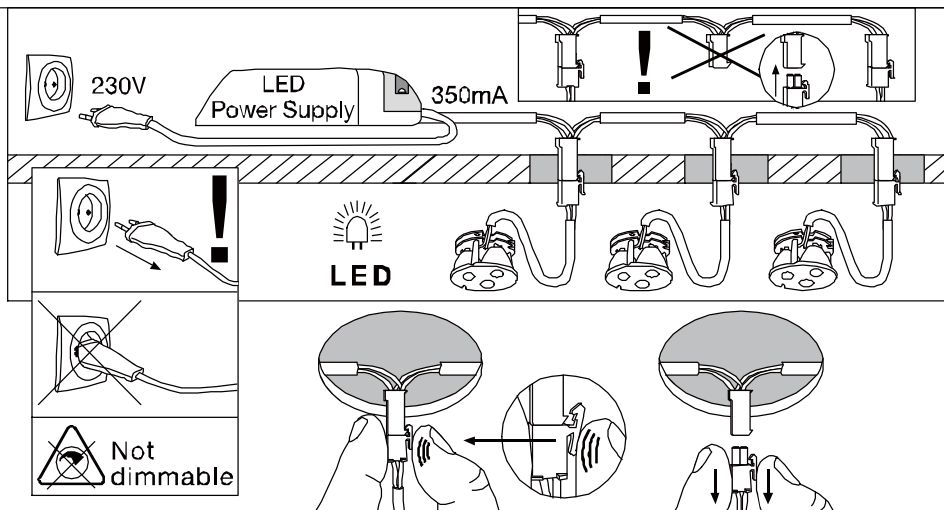

C

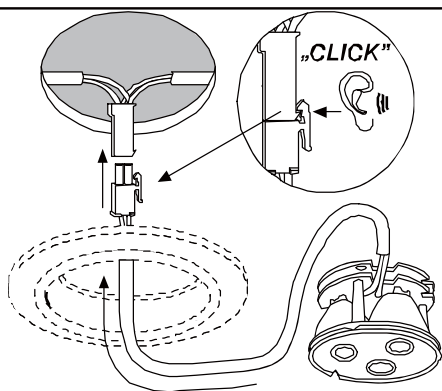

D

