

# P Paulmann

## Safety Instructions



0, 1, 2, 3, 7, 8, 9, 11, 15,  
17, 19, 20, 22



Info Hotline

+49 (0) 5041 998 389

Mon. - Do. 7<sup>00</sup> - 20<sup>00</sup>

Fr. 7<sup>00</sup> - 17<sup>00</sup>

Paulmann Licht GmbH  
31832 Springe / Germany  
www.paulmann.com

Art.-Nr.:

983.54

983.55

983.56

(+MA 173)  
PBO 05/12

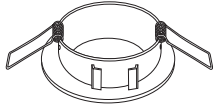

3x

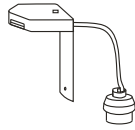

3x



3x

incl.

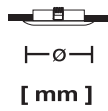
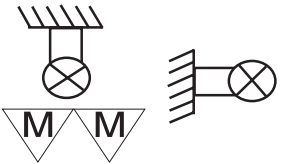
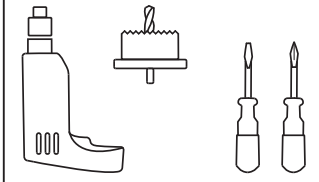

110

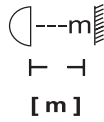

0,5



92



>120



17

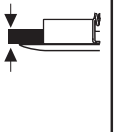

8-20

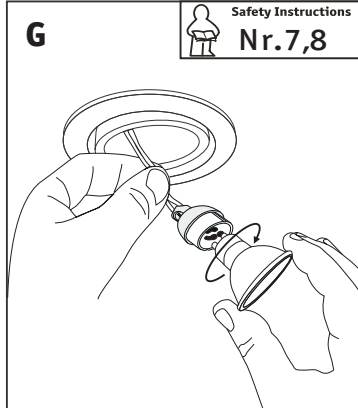
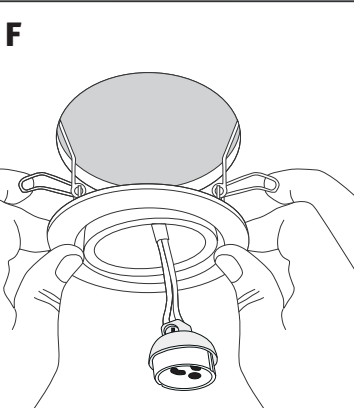
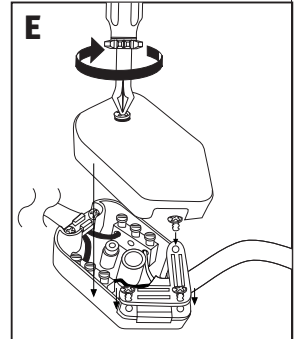
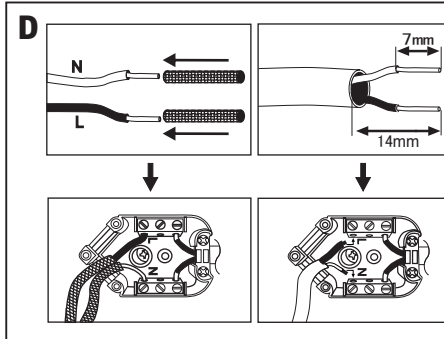
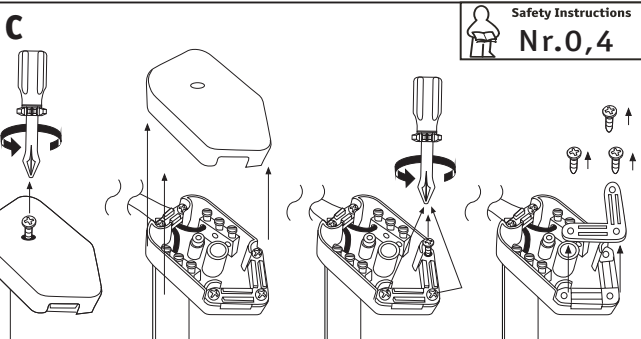
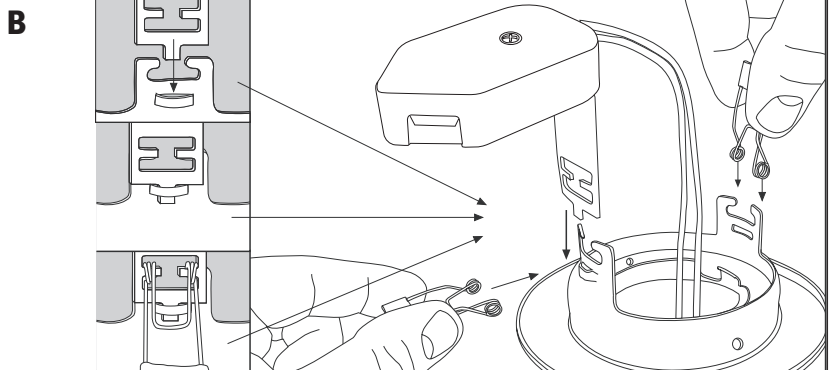
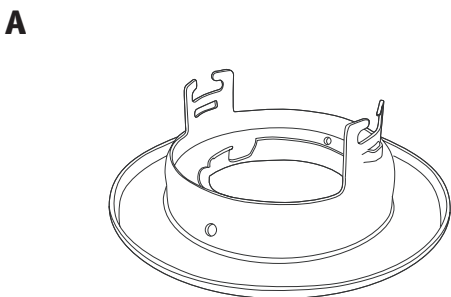

A, B, C, D, E, F, G, H



Art.No.  
11W 51mm GU10 892.38